

# Lanes Run Business Park

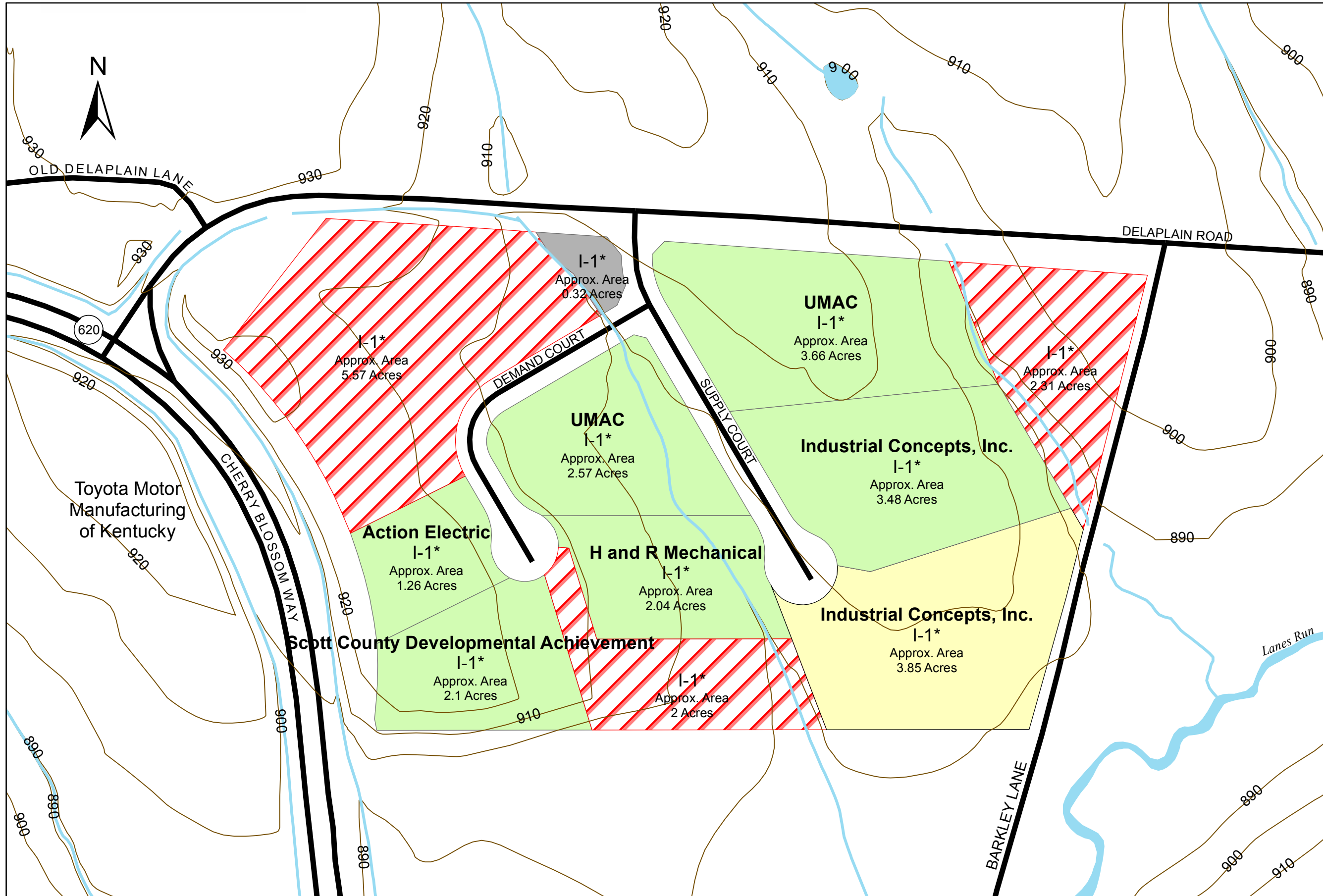

## Legend

- Creeks
- Elevation
- Streets
- Status**
- For Sale
- Pending
- Public
- Sold

For more information please contact Jack Conner at the Chamber of Commerce at 502-863-5424.

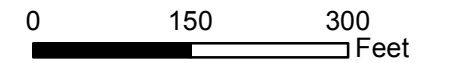

Map by the Georgetown-Scott County Planning Commission GIS  
230 E. Main St.  
Georgetown, KY 40324  
502-867-3701 Fx 502-867-3725  
www.gscplanning.com  
LanesRun\_SupplyDemand.mxd  
Printed 10/11/2011 TAR

GEORGETOWN-SCOTT CO. PLANNING COMMISSION  
GEOGRAPHIC INFORMATION SYSTEM MAPPING  
COPYRIGHT, LIMITATION OF LIABILITY AND ACCURACY STATEMENT  
The following statement is applicable to all map products produced by the Georgetown-Scott County Planning Commission Geographic Information System (GSCPCGIS). All rights are reserved.  
No part of this map may be reproduced or transmitted in any form or by any means, electronic or mechanical, including photocopying and recording, or by any information storage or retrieval system, except as expressly permitted in writing by GSCPCGIS.  
LIMITATION OF LIABILITY: GSCPCGIS has no indication or reason to believe that there are any inaccuracies or defects of information incorporated in this work and make NO REPRESENTATIONS OF ANY KIND, INCLUDING, BUT NOT LIMITED TO, THE WARRANTIES OR MERCHANTABILITY OR FITNESS FOR A PARTICULAR USE, NOR ARE ANY SUCH WARRANTIES TO BE IMPLIED WITH RESPECT TO THE INFORMATION OR DATA, FURNISHED HEREIN. INFORMATION SUPPLIED BY GSCPCGIS SHALL BE CONSIDERED GENERAL INFORMATION AND SHALL IN NO MANNER, BE USED IN LIEU OF ACTUAL ENGINEERING OR SURVEY DATA, OR APPLICABLE REGULATIONS AND REQUIREMENTS. APPLICANT FURTHER WARRANTS THAT THE INFORMATION PURCHASED SHALL BE USED EXCLUSIVELY FOR THE PURPOSE FOR WHICH IT WAS CREATED.  
GSCPCGIS aerial photography and digital mapping prepared by Photo Science, Inc., Lexington, KY. Date of photography: March 22, 1999 in accordance with the National Map Accuracy Standards. Selected areas updated November 25, 2003 by Photo Science, Inc., Lexington, KY. Only first order fully analytical stereoplotters used for stereo compilation work. Horizontal Datum is based on the Kentucky State Plane Coordinate System North Zone, North American Datum 1983 (NAD83) in US feet and tied to the Kentucky HARN Network. Vertical Datum is based on the 1988 adjustment of the National Geodetic Vertical Datum of 1929.  
\* Mapping available in digital or hard copy format in accordance with the adopted fee schedule and standards set out in the Records Request Form.