

SCOTT COUNTY, KENTUCKY CONTROL MONUMENT RECORD

Station Designation SC9910	Station Type Iron Pin w/Cap	USGS Quad	Date Set or Found March, 1999
County, State Franklin, KY	State Plane Zone KY North 1601	Horizontal Datum NAD83	Vertical Datum NAVD88
Latitude N 38° 20' 28.59672"	Northing 93496.340 (meters)	Easting 456533.734 (meters)	Elevation 222.195 (meters)
Longitude W 84° 44' 49.95610"	Northing 306745.91 (US Survey Feet)	Easting 1497811.09 (US Survey Feet)	Elevation 728.98 (US Survey Feet)
Convergence -0° 18' 33.4749"	Scale Factor 0.999964485244	Elevation Factor	Combined Factor

Station Description

To reach the monument from the intersection of Shar Rd and KY 227 go 2.85 miles Northwest along Sharp Rd to station on the left. (It is 0.5 miles NW from Scott County/Franklin County line) Station is 4.5' West of the edge of Sharp Rd, 68.5' West of a fence corner post, and 115' East of power pole #42.

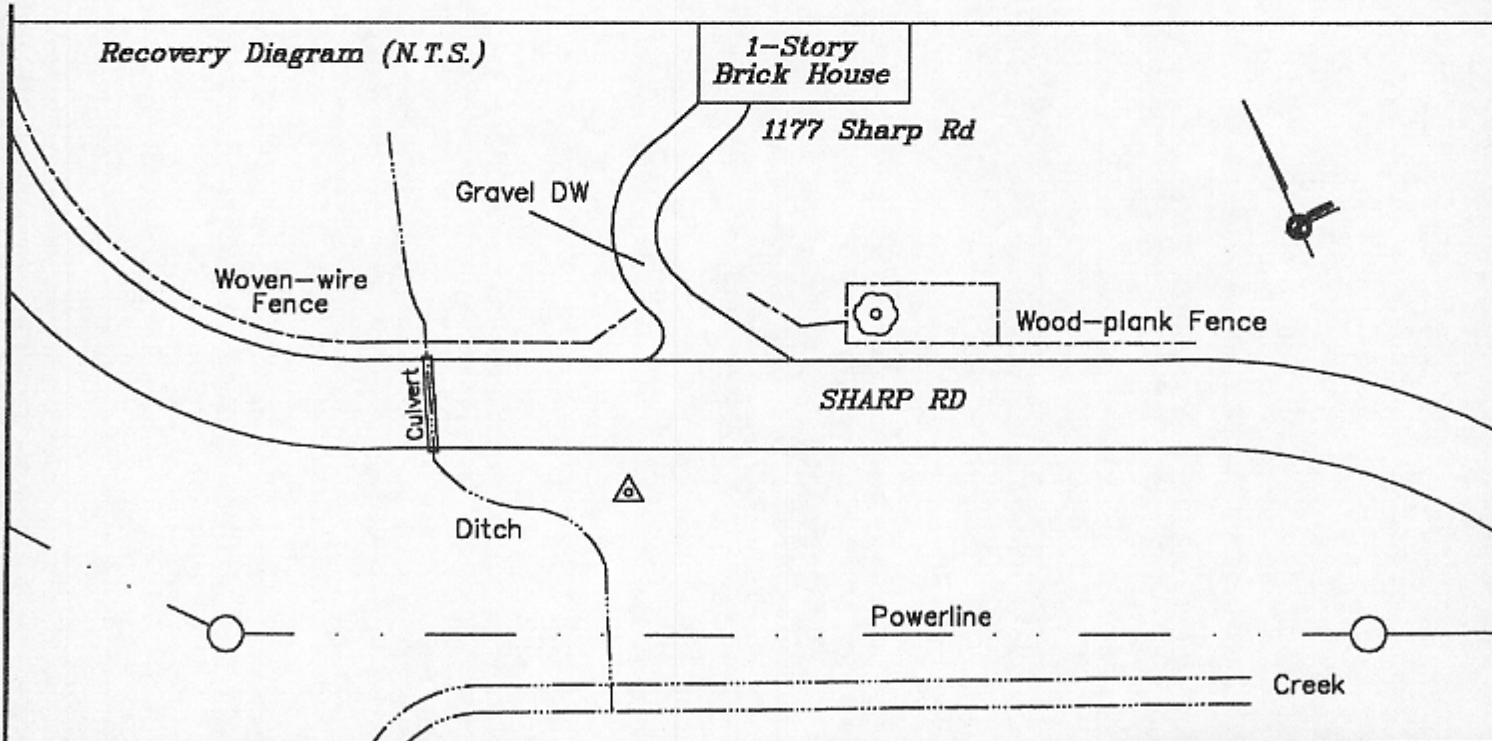

GEORGETOWN, SCOTT CO. PLANNING COMMISSION

101 EAST MAIN ST.

GEORGETOWN, KENTUCKY 40324

PH: (502) 867-3701 FAX: (502) 863-7852

MapSync

2670 Wilhite Drive Suite 4
Lexington, Kentucky 40503
Phone (806)278-8277 Fax (806)278-8645