

# GEORGETOWN, KY CONTROL MONUMENT RECORD

DESIGNATION: SC9413

TYPE: BRASS DISC STAMPED "TT 56 JRH 1952 814"

DATE SET: 1952

HORIZONTAL DATUM: NAD 83

STATE: KENTUCKY

QUAD: GEORGETOWN, KY

VERTICAL DATUM: NAD 83

COUNTY: SCOTT

ZONE: KENTUCKY N 1601

NORTHING		EASTING		ELEVATION	
78910.8367	mtr.	468613.5569	mtr.	248.335	mtr. BM
258893.303	ft.	1537442.978	ft.	814.744	ft. BM
LATITUDE: 38° 12' 37.370069" N			LONGITUDE: 84° 36' 30.173696" W		
SCALE: 0.999972075765			CONVERGENCE: -0° 13' 22.5748"		

NOTE: SITE LOCATION SKETCH IS NOT TO SCALE.

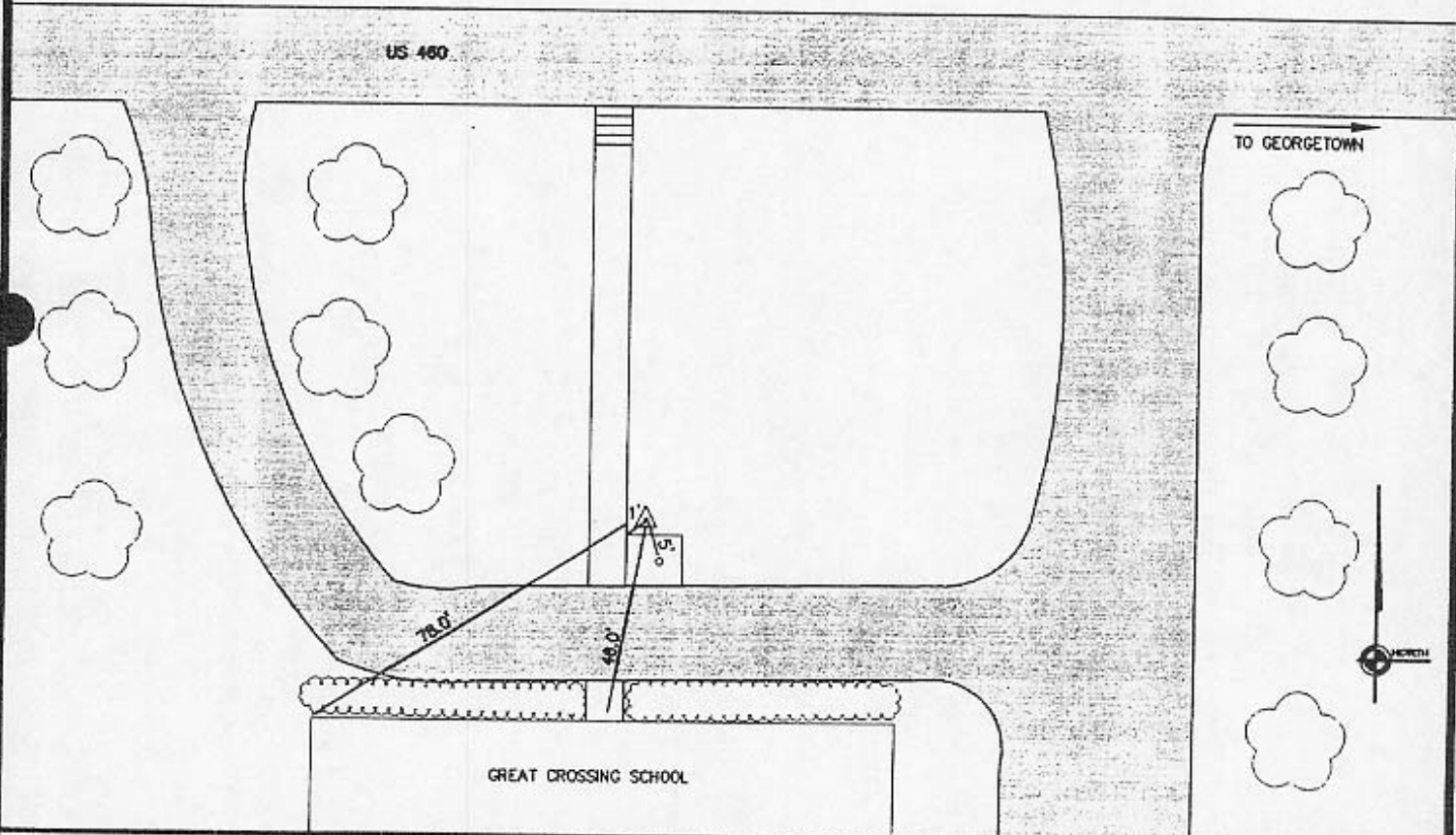

MONUMENT IS LOCATED 2.7 MILE FROM THE SCOTT COUNTY COURTHOUSE ALONG U.S. 460 AT GREAT CROSSING SCHOOL. STATION IS 78' NORTHEAST OF THE NORTHWEST CORNER OF SCHOOL BUILDING, 46' NORTH OF FRONT DOOR, 5' NORTHWEST OF FLAGPOLE, 1' NORTHEAST OF INTERSECTION OF EAST EDGE OF CONCRETE WALK AND NORTH EDGE OF CONCRETE FLAGPOLE BASE.

CITY OF GEORGETOWN, KENTUCKY

100 COURT ST., P.O. BOX 677  
 GEORGETOWN, KENTUCKY 40324  
 (502) 863-9803

**CDP**  
 ENGINEERS, INC.  
 CARTER DIXON POINDEXTER  
 516 WELLINGTON WAY, SUITE C, LEXINGTON, KENTUCKY 40503  
 PHONE: (606) 223-8000 FAX: (606) 223-8823