

# SCOTT COUNTY, KENTUCKY CONTROL MONUMENT RECORD

<b>Station Designation</b> SC9404	<b>Station Type</b> Aluminum Disc	<b>USGS Quad</b> Georgetown, KY	<b>Date Set or Found</b> June 1994
<b>County, State</b> Scott, Kentucky	<b>State Plane Zone</b> KY North 1601	<b>Horizontal Datum</b> NAD83	<b>Vertical Datum</b> NAVD88
<b>Latitude</b> N 38° 14' 02.11484"	<b>Northing</b> 81489.008 (meters)	<b>Easting</b> 479393.466 (meters)	<b>Elevation</b> 280.435 (meters)
<b>Longitude</b> W 84° 29' 07.32711"	<b>Northing</b> 267351.85 (US Survey Feet)	<b>Easting</b> 1572810.06 (US Survey Feet)	<b>Elevation</b> 920.06 (US Survey Feet)
<b>Convergence</b> -0° 08' 47.0946"	<b>Scale Factor</b> 0.999970328491	<b>Elevation Factor</b>	<b>Combined Factor</b>

## Station Description

Monument is located 1.1 mile north of US 460 and Route 922 intersection along the East side of Route 922 in front of Eastern Elementary School. Station is 43.2' East of centerline of Route 922, 28.8' Northwest to center of water meter cover, and 24.6' Southeast from center of fire hydrant.

## Recovery Diagram (N.T.S.)

ONE  
STORY  
FRAME

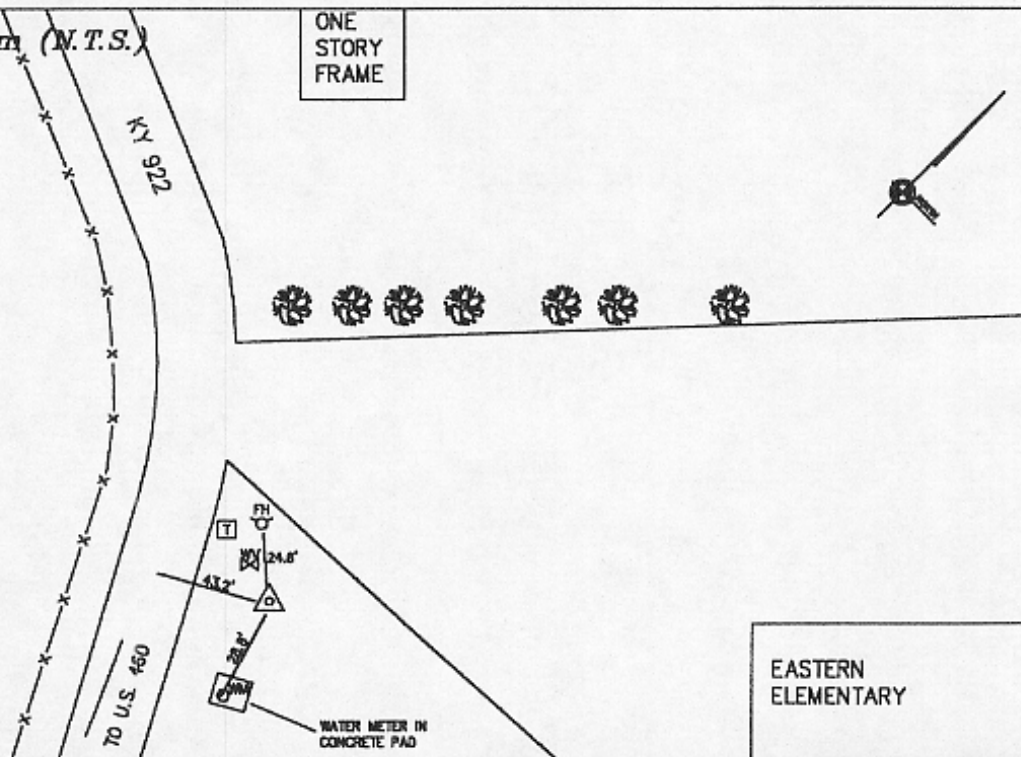

EASTERN  
ELEMENTARY

GEORGETOWN, SCOTT CO. PLANNING COMMISSION

101 EAST MAIN ST.

GEORGETOWN, KENTUCKY 40324

PH: (502) 867-3701 FAX: (502) 863-7852

MapSync

2670 Wilhite Drive Suite 4  
Lexington, Kentucky 40503  
Phone (606)278-8277 Fax (606)278-8645