

SCOTT COUNTY, KENTUCKY CONTROL MONUMENT RECORD

SCOTT COUNTY, KENTUCKY CONTROL MONUMENT RECORD			
Station Designation SC0804	Station Type Brass Disc	USGS Quad Georgetown, KY	Date Set or Found March, 2008
County, State Scott, Kentucky	State Plane Zone KY North 1601	Horizontal Datum NAD83	Vertical Datum NAVD88
Latitude N 38° 15' 57.00022"	Northing 85039.361 (meters)	Easting 476433.278 (meters)	Elevation 287.220 (meters)
Longitude W 84° 31' 09.47427"	Northing 278999.97 (US Survey Feet)	Easting 1563098.18 (US Survey Feet)	Elevation 942.32 (US Survey Feet)
Convergence -0° 10' 03.1"	Scale Factor 0.999968227	Elevation Factor 0.999960229	Combined Factor 0.999928457

Station Description

The Station is located on the north side of Corporate Blvd. near the cul-de-sac at the end. It is described as being 33.5 feet west of a curb box inlet, 26.6 feet southerly of a telephone pedestal, and 47.7 feet easterly of a sign post.

Recovery Diagram

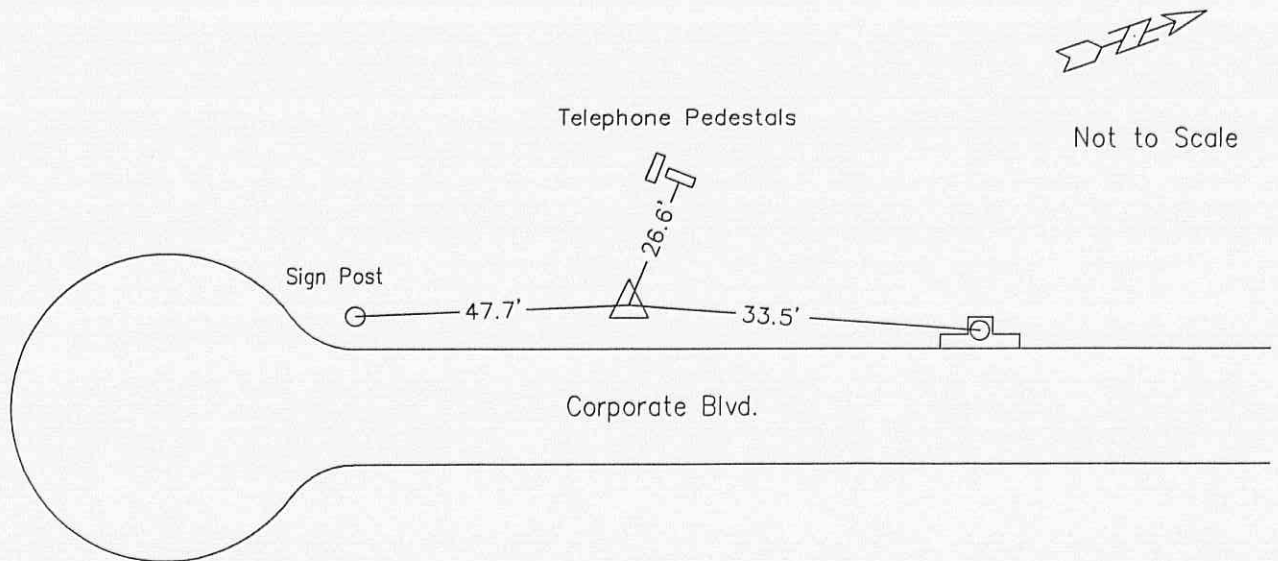

GEORGETOWN, SCOTT CO. PLANNING COMMISSION
 230 EAST MAIN STREET
 GEORGETOWN, KENTUCKY 40324
 PH: (502) 867-3701 FAX: (502) 867-3725

HDR/QUEST ENGINEERS
 2517 Sir Barton Way
 Lexington, Kentucky 40509
 Phone (859) 223-3755
 Fax (859) 223-3150