

SCOTT COUNTY, KENTUCKY CONTROL MONUMENT RECORD

Station Designation	Station Type	USGS Quad	Date Set or Found
SC0801	Brass Disc	Georgetown, KY	March, 2008
County, State Scott, Kentucky	State Plane Zone KY North 1601	Horizontal Datum NAD83	Vertical Datum NAVD88
Latitude N 38° 15' 59.60164"	Northing 851117.472 (meters)	Easting 477162.306 (meters)	Elevation 291.210 (meters)
Longitude W 84° 30' 39.49318"	Northing 279256.24 (US Survey Feet)	Easting 1565490.00 (US Survey Feet)	Elevation 955.41 (US Survey Feet)
Convergence -0° 09' 44.4"	Scale Factor 0.999968183	Elevation Factor 0.999959604	Combined Factor 0.999927788

Station Description

The Station is located on the south side of Corporate Blvd. It is described as being 413.0 feet westerly from a fire hydrant located at the intersection of Corporate Blvd. and US 62, 53.0 feet westerly of a curb box inlet on the south side of Corporate Blvd. (being the third curb box inlet west of the intersection of Corporate Blvd. and US 62), and 17.5 feet southerly of the south face of curb of Corporate Blvd.

Recovery Diagram

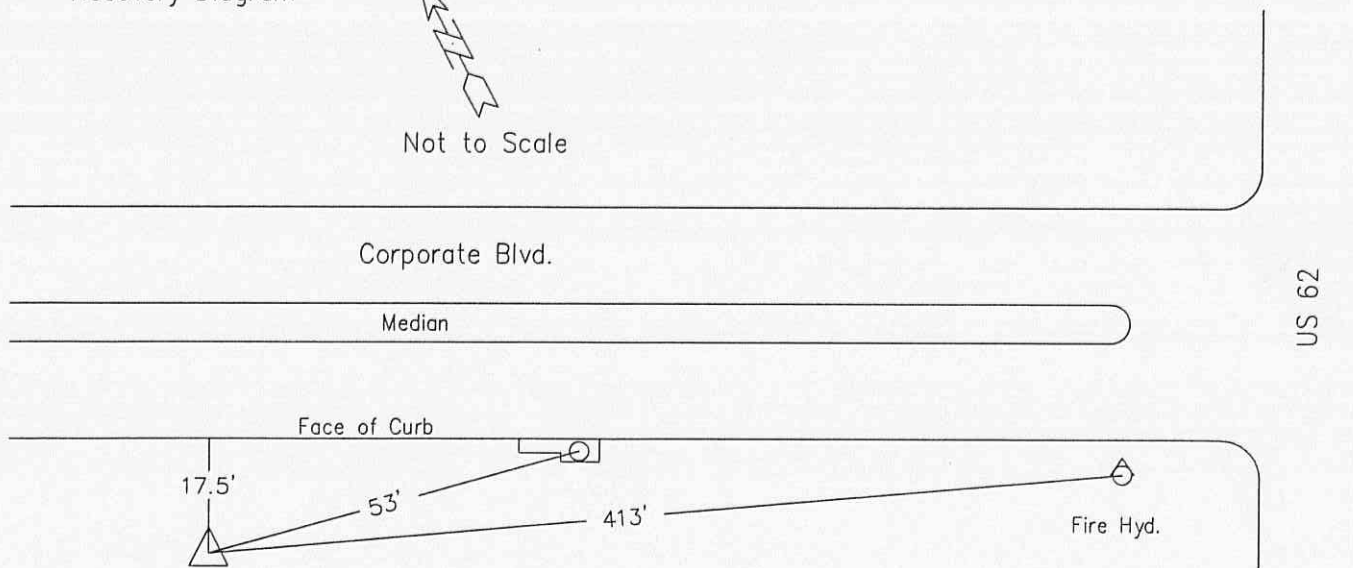
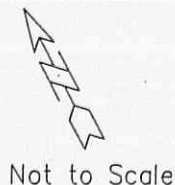

GEORGETOWN, SCOTT CO. PLANNING COMMISSION
 230 EAST MAIN STREET
 GEORGETOWN, KENTUCKY 40324
 PH: (502) 867-3701 FAX: (502) 867-3725

HDR/QUEST ENGINEERS
 2517 Sir Barton Way
 Lexington, Kentucky 40509
 Phone (859) 223-3755
 Fax (859) 223-3150