

SCOTT COUNTY, KENTUCKY CONTROL MONUMENT RECORD

Station Designation <u>SC0205</u>	Station Type <u>Brass Disc</u>	USGS Quad <u>Georgetown, KY</u>	Date Set or Found <u>November, 2002</u>
County, State <u>Scott, Kentucky</u>	State Plane Zone <u>KY North 1601</u>	Horizontal Datum <u>NAD83</u>	Vertical Datum <u>NAVD88</u>
Latitude <u>N 38° 12' 32.11603"</u>	Northing <u>78739.227</u> (meters)	Easting <u>471189.791</u> (meters)	Elevation <u>266.315</u> (meters)
Longitude <u>W 84° 34' 44.25055"</u>	Northing <u>258330.28</u> (US Survey Feet)	Easting <u>1545895.17</u> (US Survey Feet)	Elevation <u>873.74</u> (US Survey Feet)
Convergence <u>-0° 12' 16.7"</u>	Scale Factor <u>0.9999721896</u>	Elevation Factor <u>0.99996357</u>	Combined Factor <u>0.99993576</u>

Station Description

Station is located at the intersection of U.S. 460 and ^{Paynes Depot Rd} ~~U.S. 62~~. It is further described as being 23.2 feet North of a power pole, 77.6 feet Northwest of the corner post of a wood plank fence, 23.7 feet East of a tree, 39.0' East of the Welcome sign, and 46.8 feet South of the south edge of U.S. 460.

Recovery Diagram (N.T.S.)

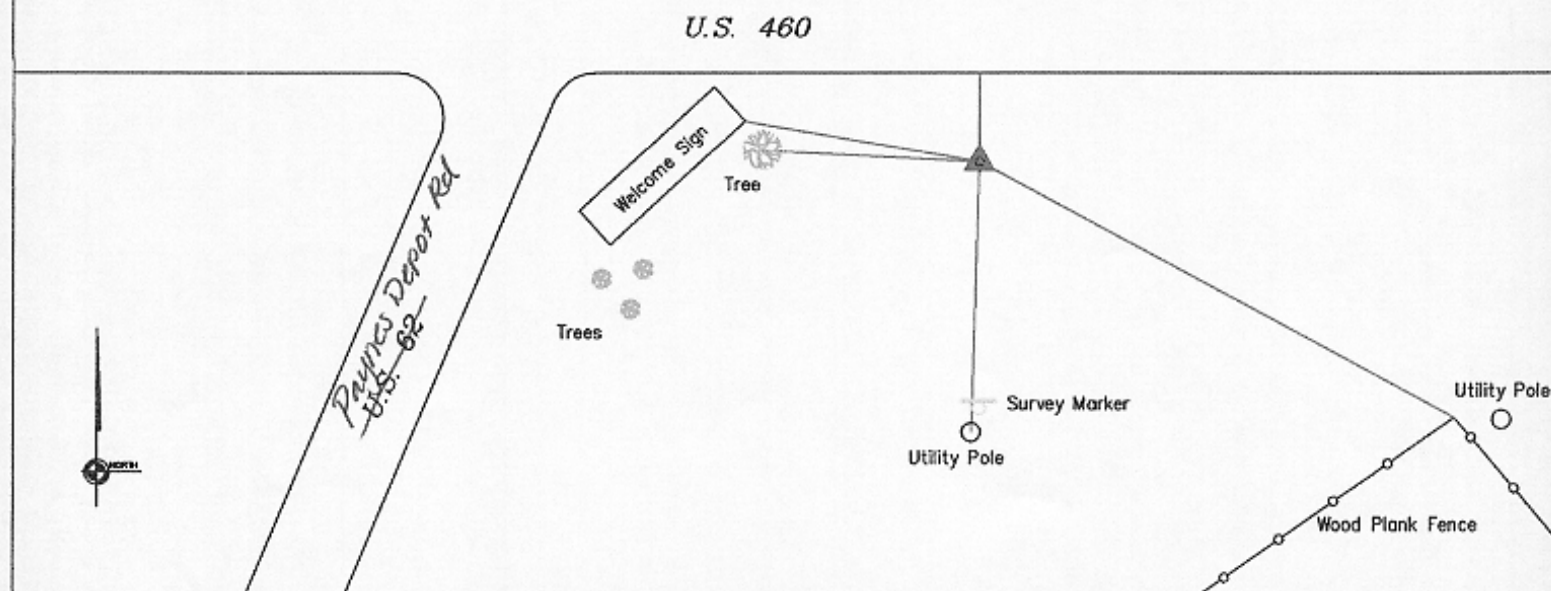

GEORGETOWN, SCOTT CO. PLANNING COMMISSION
 230 EAST MAIN ST.
 GEORGETOWN, KENTUCKY 40324
 PH: (502) 867-3701 FAX: (502) 867-3725

MapSync
 2628 Wilhite Court
 Building 4 Suite 102
 Lexington, Kentucky 40503
 Phone (859) 278-6277 Fax (859) 278-8645