

SCOTT COUNTY, KENTUCKY CONTROL MONUMENT RECORD

<i>Station Designation</i> <u>SC0202</u>	<i>Station Type</i> <u>Brass Disc</u>	<i>USGS Quad</i> <u>Delaplain, KY</u>	<i>Date Set or Found</i> <u>November, 2002</u>
<i>County, State</i> <u>Scott, Kentucky</u>	<i>State Plane Zone</i> <u>KY North 1601</u>	<i>Horizontal Datum</i> <u>NAD83</u>	<i>Vertical Datum</i> <u>NAVD88</u>
<i>Latitude</i> <u>N 38° 16' 47.01137"</u>	<i>Northing</i> <u>86594.950</u> (meters)	<i>Easting</i> <u>472168.725</u> (meters)	<i>Elevation</i> <u>277.494</u> (meters)
<i>Longitude</i> <u>W 84° 34' 05.12674"</u>	<i>Northing</i> <u>284103.59</u> (US Survey Feet)	<i>Easting</i> <u>1549106.89</u> (US Survey Feet)	<i>Elevation</i> <u>910.41</u> (US Survey Feet)
<i>Convergence</i> <u>-0° 11' 52.3"</u>	<i>Scale Factor</i> <u>0.9999674089</u>	<i>Elevation Factor</i> <u>0.99996184</u>	<i>Combined Factor</i> <u>0.99992925</u>

Station Description

From the intersection of KY 620 (Delaplain Road) and U.S. 25 (Cincinnati Pike) proceed North on U.S. 25 for 0.08 miles to the station on the left. The station is located at Fire Station #1, 2200 Cincinnati Pike, it is further described as being 10.7 feet Southwest of the Southeast corner of a concrete block sign, 49.5 feet West of the edge of U.S. 25, 70.0 feet Northwest of an electric pole, 14.5 feet East of the edge of the blacktop drive, and 9.6' Southwest of the survey marker.

Recovery Diagram (N.T.S.)

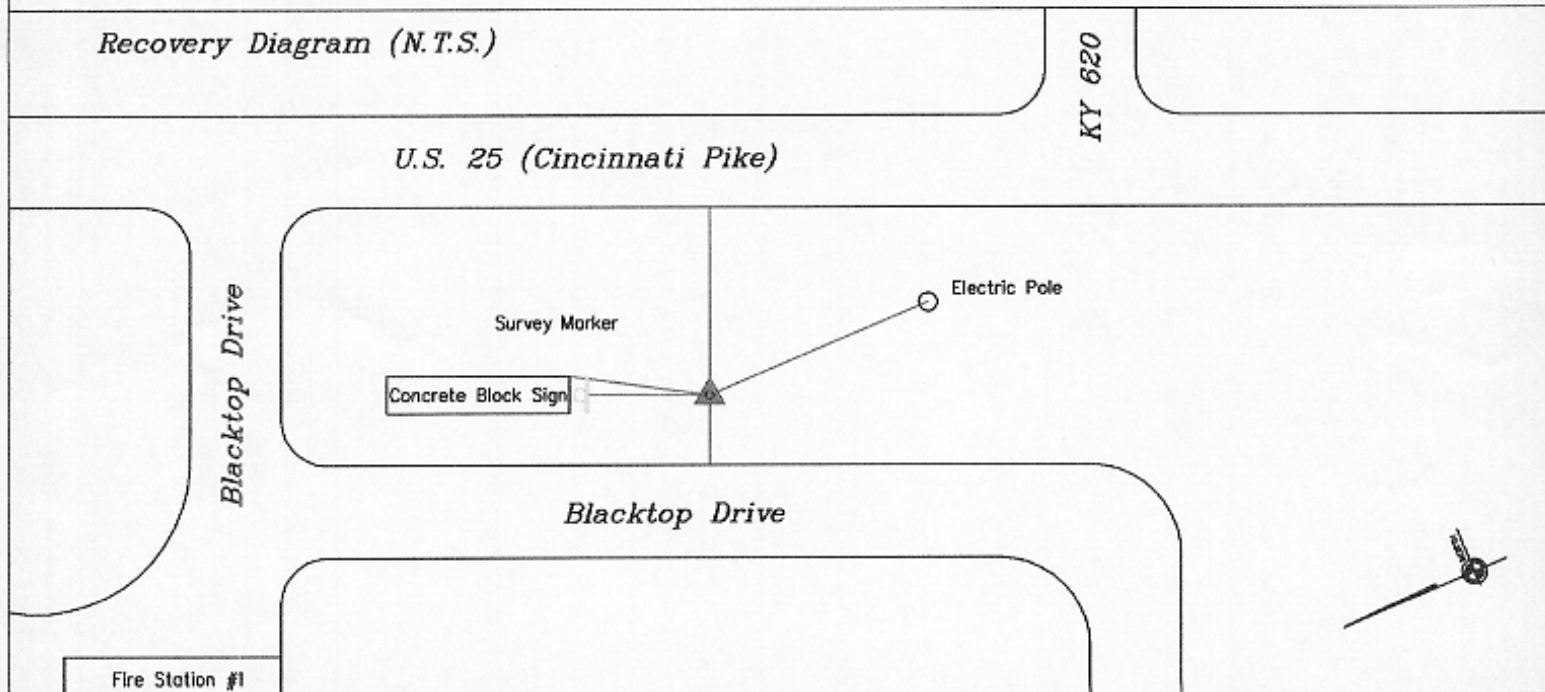

GEORGETOWN, SCOTT CO. PLANNING COMMISSION

230 EAST MAIN ST.

GEORGETOWN, KENTUCKY 40324

PH: (502) 867-3701 FAX: (502) 867-3725

MapSync

2628 Wilhite Court
Building 4 Suite 102

Lexington, Kentucky 40503

Phone (859) 278-6277 Fax (859) 278-8645